

Standard oil-mist lubricator, Series 651

- G 1/8 G 1/4

- Nominal flow Qn 900 1940 l/min

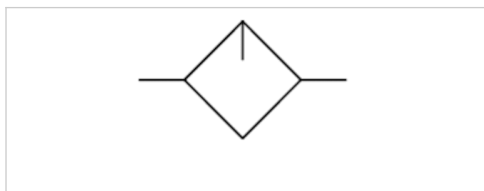

Type

Parts

Working pressure min./max.

Ambient temperature min./max.

Medium temperature min./max.

Medium

Lubricator reservoir volume

Weight

Can be assembled into blocks

Standard oil-mist lubricator

0 ... 10 bar

5 ... 50 °C

5 ... 50 °C

Compressed air Neutral gases

42 cm³

See table below

The delivered product varies from that in the illustration. See the drawing for an exact description.

Technical data

Part No.	Port	Nominal flow Qn	Material Reservoir	Reservoir
G651AL0K10A0000	G 1/8	900 l/min	Aluminum	Metal reservoir without window
G651AL0L10A0000	G 1/8	900 l/min	Aluminum	reservoir, metal, with inspection glass
G651AL0K20A0000	G 1/4	1940 l/min	Aluminum	Metal reservoir without window
G651AL0L20A0000	G 1/4	1940 l/min	Aluminum	reservoir, metal, with inspection glass
G651AL0P10A0000	G 1/8	900 l/min	Polycarbonate	Reservoir polycarbonate
G651AL0P20A0000	G 1/4	1940 l/min	Polycarbonate	Reservoir polycarbonate

Part No.	Weight
G651AL0K10A0000	0,33 kg
G651AL0L10A0000	0,33 kg
G651AL0K20A0000	0,33 kg
G651AL0L20A0000	0,33 kg
G651AL0P10A0000	0,24 kg
G651AL0P20A0000	0,24 kg

Nominal flow Qn at 6.3 bar and $\Delta p = 0.8$ bar

Technical information

Recommended oil type

Non-detergent type and without aggressive additives (VG32-ISO3448)

Technical information

Material	
Housing	Aluminum
Front plate	Polycarbonate
Seals	Nitrile butadiene rubber
Reservoir	Aluminum Polycarbonate

Dimensions

Dimensions

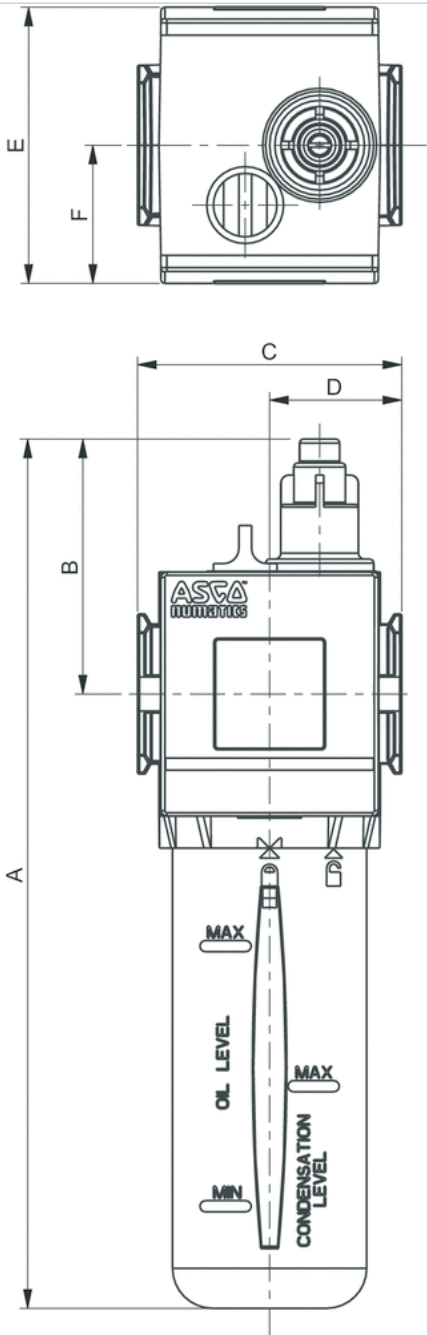

To remove the reservoir, allow a clearance of 20 mm from the bottom of the reservoir drain.

Dimensions

Series	A	B	C	D	E	F	G
651	198	58	50	25	58	29	116

Accessories overview

Accessories overview

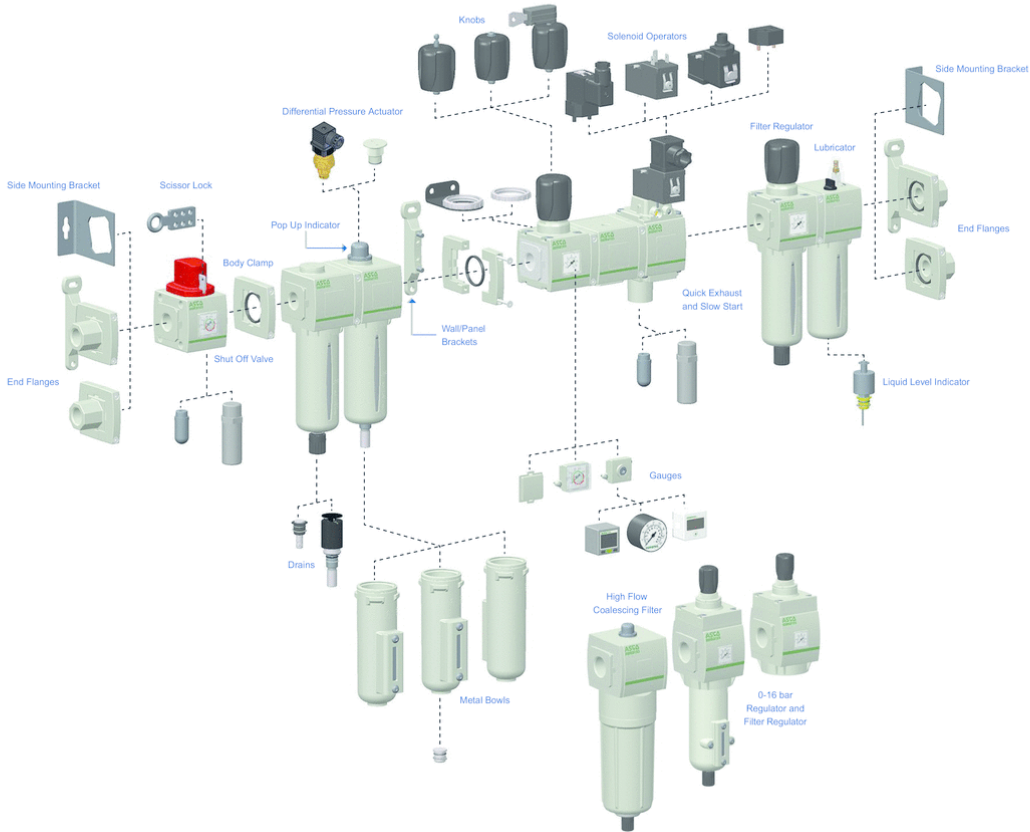

Ordering information

Thread connection

G = ISO 228/1-G ⁽¹⁾

8 = NPTF

Product series

651

652

653

Revision letter

A

Product type

L = Lubricator

Bowl Type

K = Metal Bowl without Sight Gauge

L = Metal bowl with sight gauge (glass)

P = Polycarbonate bowl with bowl guard

K/L

P



G

651

A

L

0

P

2

0

A00

0

0

Options ⁽²⁾

A00 = Without option

101 = Side Mounting Brackets

108 = Liquid Level Indicator - Electronic

109 = FPM seals

117 = ATEX zones 1-21 

124 = CUTR Certification (EAC)

125 = CUTR Ex

101

108



Port size

1 = 1/8 (651 Series)

2 = 1/4 (651 or 652 Series)

3 = 3/8 (652 Series)

4 = 1/2 (652 Series)

5 = 3/4 (653 Series)

6 = 1 (653 Series)

⁽¹⁾ Conforms to ISO standards 1179-1.

⁽²⁾ If multiple options are required, please use the on-line CAD configurator on the website to generate the part number (www.asco.com).

Efficient pneumatic solutions, our program: cylinders and drives, valves and valve systems, air supply management



Visit us: [Emerson.com/Aventics](https://www.emerson.com/Aventics)

Your local contact: [Emerson.com/contactus](https://www.emerson.com/contactus)



Emerson.com



Facebook.com/EmersonAutomationSolutions



LinkedIn.com/company/Emerson-Automation-Solutions



Twitter.com/EMR_Automation

An example configuration is depicted on the title page. The delivered product may thus vary from that in the illustration. Subject to change. This Document, as well as the data, specifications and other information set forth in it, are the exclusive property of AVENTICS GmbH. It may not be reproduced or given to third parties without its consent. Only use the AVENTICS products shown in industrial applications. Read the product documentation completely and carefully before using the product. Observe the applicable regulations and laws of the respective country. When integrating the product into applications, note the system manufacturer's specifications for safe use of the product. The data specified only serve to describe the product. No statements concerning a certain condition or suitability for a certain application can be derived from our information. The information given does not release the user from the obligation of own judgement and verification. It must be remembered that the products are subject to a natural process of wear and aging.

The Emerson logo is a trademark and service mark of Emerson Electric Co. Brand logotype are registered trademarks of one of the Emerson family of companies. All other marks are the property of their respective owners. © 2020 Emerson Electric Co. All rights reserved.
2020-12



CONSIDER IT SOLVED™